

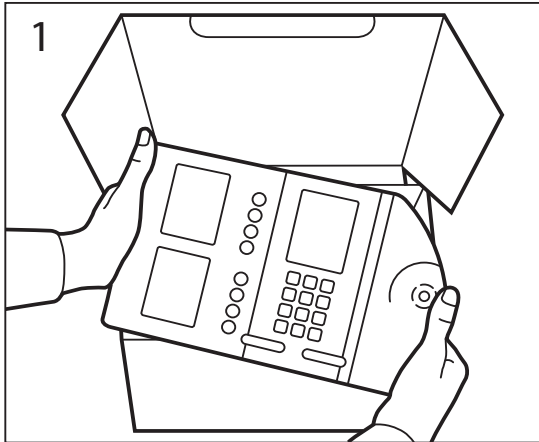

WWW.SPEAKERBUS.COM

# Speakerbus iD808 Stand Instructions

## Extending Legs



1  
Take item out of box.

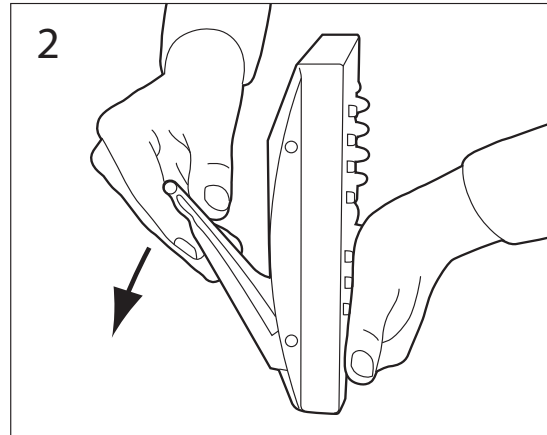

2  
Un-fold legs to desired position. Ensure both legs are adjusted to the same height.

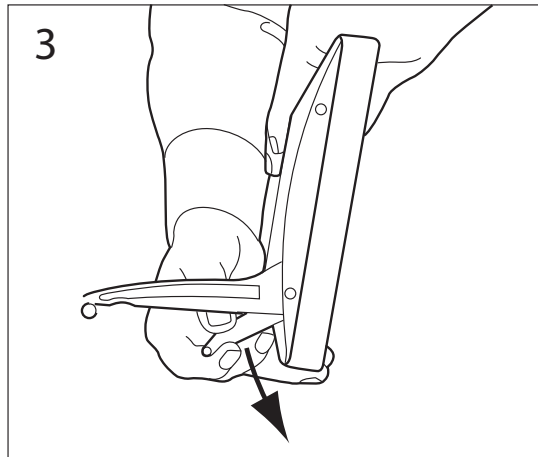

3  
This step is only required if the unit is positioned behind a keyboard. Un-click leg lifters behind leg and un-fold them until they click in latch. Ensure both leg lifters are adjusted to the same height.

## Collapsing Legs

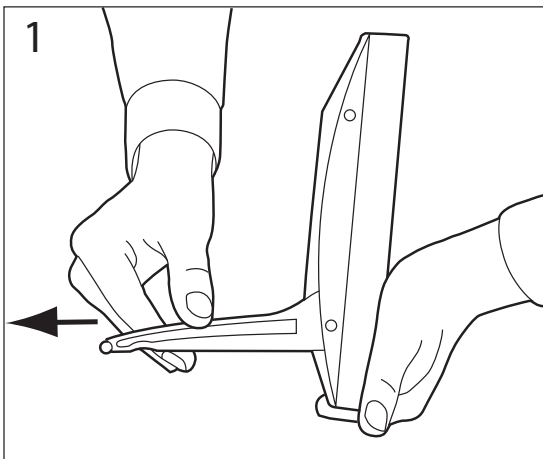

1  
Pull leg outwards until it un-locks.

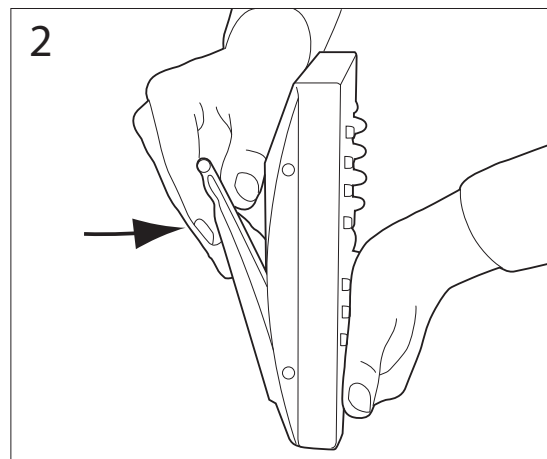

2  
Collapse leg to folded position.